

TARGET NOZZLE

The Target nozzle is a precision instrument designed to give many years of trouble free service. Some times small particles can get lodged in the nozzle head obstructing the flow of fluid. These obstructions can easily be removed by following the following instructions

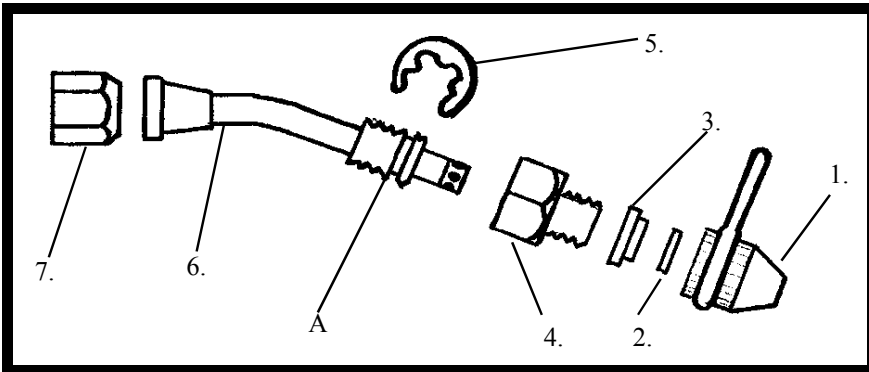

#1	Nozzle Head
#2	Teflon Washer
#3	One-Way Brass Washer
#4	Threaded Collar
#5	C-Clip
#6	Bent Extension

DISASSEMBLY

1. Rotate nozzle head assembly all the way forward until it stops (do not force it). Back it off one complete turn.
2. Holding Item #4 (threaded collar) still with a wrench un-screw item #1 {nozzle head} taking care not to lose the two washers (items 2 & 3)
3. If it is necessary to remove the threaded collar from the bent extension, the C-clip (item # 5) must be removed from groove "A"

CLEANING

1. To remove a nozzle obstruction tap the nozzle head base down on a hard surface.
2. If still blocked, use a strand of copper wire from an electrical power lead.

NEVER USE A PIN OR NEEDLE, THIS WILL DAMAGE THE NOZZLE

RE-ASSEMBLY

1. Slip nozzle attachment nut over bent extension. Screw threaded collar past groove and install C-clip.
2. Screw collar forward until it stops and turn it back one turn. Slip the one way brass washer over the end of the bent extension. *The smaller shoulder on the washer must be pointing forward.*
3. Slip the white Teflon Washer over the end of bent extension (the washer may be inside the nozzle head, it can be left there). Screw on the nozzle head, tightening it so that the nozzle assembly moves as an assembly. If the nozzle leaks, tighten the head against the collar (This action Compresses the Teflon washer and seals the nozzle)

CUSTOMER LINE: 800/564-1096 • PHONE: 805/965-0704 • FAX: 805/963-7794

SHIPPING
927 Indio Muerto St.
Santa Barbara, CA 93103

MAILING
P.O. Box 4700
Santa Barbara, CA 93140

ATLANTA SHIPPING
879 Davis Drive
Conyers, GA 30207